

LEADING THROUGH EXCELLENCE SINCE 1990

Kung Long Batteries established in 1990, we are the only listed specialist lead-acid battery manufacturer in Taiwan. In addition to our first factory in Taiwan, we have two more modern production facilities in Vietnam and our group has passed ISO 9001, ISO 45001, ISO 17025 and IATF 16949 certification.

Because of our untiring efforts of product innovation and development and proactive attitude, since 1993 Kung Long has cooperated with the Industrial Technology Research Institute's Material & Chemical Research Laboratories on the development of deep-cycle sealed batteries, electric scooter batteries, and high-power surface modified batteries.

In addition to our amazing team of employees who create our quality products, we have built advanced facilities using the latest technologies to enhance the performance and quality the batteries. Under precise manufacturing standards and insurance of product compliance of quality management systems, our entire collection of sealed lead-acid battery products have passed UL safety standards and also passed German VdS certification to meet quality demands of the security system market in the European region.

Renowned international corporations both domestic and overseas have voiced support and affirmation of our products' quality. We believe that customer satisfaction is not only from the product itself, but is also built from immediate service and establishment of a friendly working relationship with clients those are measures to provide extra value and enhance customer satisfaction.

Thus, Kung Long earned the Gold Award for Customer Satisfaction, and also earned the honor of the Taiwan Excellence Award from the Ministry of Economic Affairs as we believe that the pursuit of innovative products is not for the sake of the product itself, but is firmly rooted in customer's desires for solutions.



KUNG LONG TAIWAN



INSIDE THE FACTORY



LE LONG VIETNAM

OUR EXPERTISE COMES FROM OUR AMPLE EXPERIENCES

<p>1990</p> <ul style="list-style-type: none"> • Kung Long Was Approved To Establish In Nan Kang Industrial Park 	<p>2023</p> <ul style="list-style-type: none"> • Obtained IATF 16949 Automotive Quality Management System
<p>1991</p> <ul style="list-style-type: none"> • Obtained UL Mark For US Product Safety Standards 	<p>2022</p> <ul style="list-style-type: none"> • Awarded Kaizen Champion by Schneider Electric (SE)
<p>1993</p> <ul style="list-style-type: none"> • Developed Deep-cycle SLA Batteries With Industrial Technology Research Institute's Material And Chemical Research Laboratories 	<p>2021</p> <ul style="list-style-type: none"> • HTP12100A Awarded "Taiwan Excellence" By Ministry Of Economic Affairs
<p>1997</p> <ul style="list-style-type: none"> • Awarded With The " Gold Award For Customer Satisfaction" 	<p>2020</p> <ul style="list-style-type: none"> • Obtained ISO 45001 Occupational Health And Safety Management Systems
<p>1998</p> <ul style="list-style-type: none"> • Awarded With The " Excellence Of Taiwan Award" By The Ministry Of Economic Affairs. 	<p>2019</p> <ul style="list-style-type: none"> • Awarded Excellent Supplier by Honda Vietnam
<p>1999</p> <ul style="list-style-type: none"> • Obtained ISO 14001 International Environmental Certificate 	<p>2018</p> <ul style="list-style-type: none"> • Qualified Supplier by TOP 3 Telecom companies in Taiwan - Chunghwa Telecom (CHT), Taiwan Mobile, and Far EasTone Telecom • Qualified Supplier by GDS Data Center in Vietnam
<p>2000</p> <ul style="list-style-type: none"> • Obtained ISO 9001 International Quality Management System Certificate 	<p>2017</p> <ul style="list-style-type: none"> • Obtained ISO 17025 Certificate of Accreditation • Awarded CHAMPION of Excellent Supplier By Schneider Electric (SE) • Qualified Supplier by TOP 3 Telecom companies in Vietnam - Viettel, VNPT, and VinaPhone
<p>2001</p> <ul style="list-style-type: none"> • Approved For A Listed Company In Taiwan Stock Exchange Market. (Twse:1537) 	<p>2016</p> <ul style="list-style-type: none"> • Developed And Accomplished High Temperature Batteries, HTP Series
<p>2002</p> <ul style="list-style-type: none"> • Obtained OHSAS 18001 International Safety Management System Certificate • Qualified By APC By Schneider Electric (SE) 	<p>2015</p> <ul style="list-style-type: none"> • Qualified By Honda For Iss Motorcycle Battery • Qualified As Green Supplier By Schneider Electric (SE)
<p>2007</p> <ul style="list-style-type: none"> • Established The 2nd Plant (Duc Hoa) In Vietnam Where Occupies 350,000 Square Meters 	<p>2012</p> <ul style="list-style-type: none"> • Developed And Accomplished Long Life Batteries, WPL Series • Qualified Supplier From Various Public Transportation System Continuously In Taiwan, Including Taipei, Taoyuan, Hsinchu, Taichung, Tainan, And Kaohsiung. • Le Long Vietnam Co., Obtained ISO 14001 And OHSAS 18001
<p>2008</p> <ul style="list-style-type: none"> • Obtained TL 9000 Quality Management System Certificate In Vietnam 	<p>2011</p> <ul style="list-style-type: none"> • BI (Business Intelligence) System On Line
<p>2010</p> <ul style="list-style-type: none"> • Introduce New CI (Corporate Identity) • Developed And Accomplished Stationary Batteries, MSK & TPK Series 	



FEATURES

1. Long design life in float service
2. Suitable for long string usage
3. Thinner plate design with high charging acceptance
4. COS / TTP welding
5. Low internal resistance and low self-discharge rate < 2%/month
6. Using High-Purity Lead (> 99.99%)
7. ABS optional ABS case with UL 94V-0 flame retardant rating (LOI>28%)

TOP TERMINAL TYPE (EUROBAT CLASSIFICATION : LONG LIFE 10/12 YEARS)

BATTERY MODEL	NOMINAL VOLTAGE (V)	20 hr Rate to 1.75V/cell at (25°C)	@15 min Rate to 1.67V/cell at (25°C)	DIMENSION				WEIGHT (APPROX.) kg	SHORT CIRCUIT CURRENT (A) IEC 60896 21-22	IR (mΩ)	TERMINAL POSITION	TERMINAL TYPE
				L mm	W mm	H mm	HT mm					
WXL12245WN	12	65	245W	350	167	179	179	20.50	1700	6	9	F18
WXL12265WN	12	70	265W	350	167	179	179	22.50	1850	3.9	9	F18
WXL12300WN	12	75	300W	260	170	202	207	24.20	2000	5	9	F18
WXL12365WN	12	95	365W	306	168	206	213	29.50	2350	5	9	F18
WXL12420WN	12	110	420W	341	173	215	219	34.00	3660	3.9	9	F18
WXL12450WN	12	115	450W	376	172	221	225	37.50	3750	2.5	9	F18
WXL12505WN	12	130	505W	338	173	276	281	42.00	3183	4	9	F18
WXL12550WN	12	140	550W	338	173	276	281	45.00	3850	3.5	9	F18
WXL12710WN	12	200	710W	532	207	214	219	58.00	3350	3	22	F18
WXL12820WN	12	230	820W	522	238	219	224	66.40	4040	2.5	22	F18

FRONT TERMINAL TYPE (EUROBAT CLASSIFICATION : VERY LONG LIFE >12 YEARS)

WXL12345WFT	12	100	345W	507	106	235	235	30.00	2124	4.3	23	F18
WXL12450WFT	12	150	450W	550	110	288	288	44.30	2432	4.5	23	F18
WXL12500WFT	12	150	500W	550	110	288	288	50.50	2670	4.5	23	F18
WXL12600WFT	12	160	600W	550	110	288	288	54.00	2800	3.2	23	F18
WXL12710WFT	12	190	710W	546	125	320	320	60.00	3481	3.8	23	F18



DISCHARGE WATTS PER CELL TO 1.67V/cell AT 25°C

BATTERY MODEL	MINUTES					
	5	10	15	20	30	60
WXL12245WN	423	323	249	209	153	87.9
WXL12265WN	484	340	262	214	159	92.5
WXL12300WN	633	435	340	268	203	98.9
WXL12365WN	747	484	365	291	216	123
WXL12420WN	805	547	444	335	249	146
WXL12450WN	869	601	477	360	288	164
WXL12505WN	837	615	508	403	291	142
WXL12550WN	1023	738	553	462	325	175
WXL12710WN	1180	848	711	605	467	268
WXL12820WN	1200	964	818	624	493	284
WXL12500WFT	643	542	499	-	297	187
WXL12710WFT	950	827	708	-	485	270

DISCHARGE WATTS PER CELL TO 1.70V/cell AT 25°C

BATTERY MODEL	MINUTES					
	5	10	15	20	30	60
WXL12245WN	409	314	247	206	152	87.4
WXL12265WN	467	334	259	212	158	92.3
WXL12300WN	608	426	333	265	201	98.7
WXL12365WN	726	474	359	287	214	122
WXL12420WN	775	533	441	332	247	146
WXL12450WN	837	586	474	357	285	164
WXL12505WN	797	605	505	393	287	139
WXL12550WN	963	705	543	457	322	173
WXL12700WN	996	819	702	586	449	259
WXL12780WN	1142	919	778	599	479	276
WXL12500WFT	613	525	489	-	291	186
WXL12710WFT	921	777	683	-	470	269

DISCHARGE WATTS PER CELL TO 1.75V/cell AT 25°C

BATTERY MODEL	MINUTES					
	5	10	15	20	30	60
WXL12245WN	390	295	244	203	150	86.6
WXL12265WN	442	317	252	207	156	91.7
WXL12300WN	573	415	326	261	197	98.4
WXL12365WN	686	454	345	277	208	119
WXL12420WN	738	518	439	329	244	145
WXL12450WN	797	570	472	353	282	163
WXL12505WN	740	587	479	377	281	148
WXL12550WN	893	672	530	450	317	171
WXL12710WN	997	805	679	560	432	248
WXL12820WN	1083	874	750	574	464	269
WXL12500WFT	580	505	456	-	272	182
WXL12710WFT	881	728	629	-	450	267

DISCHARGE WATTS PER CELL TO 1.80V/cell AT 25°C

BATTERY MODEL	MINUTES					
	5	10	15	20	30	60
WXL12245WN	361	271	225	190	147	85.9
WXL12265WN	404	304	245	202	152	90
WXL12300WN	530	400	311	250	187	97.9
WXL12365WN	639	428	328	264	199	116
WXL12420WN	675	503	424	321	236	143
WXL12450WN	729	553	456	345	274	161
WXL12505WN	683	542	433	354	271	147
WXL12550WN	803	630	515	440	312	163
WXL12710WN	957	790	644	545	413	237
WXL12820WN	1024	829	678	549	449	261
WXL12500WFT	523	450	405	-	241	175
WXL12710WFT	792	673	569	-	426	260





FEATURES

1. Special design for Water-Cooled or Air-Cooled Environment
2. Wide Operating Temperature
3. Correspond to market needs to achieve the mission of "Energy Saving and Carbon Reduction"
4. Longer life in a high-temperature environment
5. More achievements in green energy and friendly environment
6. Reduce the frequency of battery replacement to save the cost

TOP TERMINAL TYPE (EUROBAT CLASSIFICATION : LONG LIFE 10/12 YEARS)

BATTERY MODEL	NOMINAL VOLTAGE (V)	20 hr Rate to 1.75V/cell at (25°C)	@15 min Rate to 1.67V/cell at (25°C)	DIMENSION				WEIGHT (APPROX.) kg	SHORT CIRCUIT CURRENT (A) IEC 60896 21-22	IR (mΩ)	TERMINAL POSITION	TERMINAL TYPE
				L mm	W mm	H mm	HT mm					
HTP12245WN	12	65	245W	350	167	179	179	20.50	1700	6	9	F18
HTP12265WN	12	70	265W	350	167	179	179	22.50	1850	3.9	9	F18
HTP12300WN	12	75	300W	260	170	202	207	24.20	2000	5	9	F18
HTP12365WN	12	95	365W	306	168	206	213	29.50	2350	5	9	F18
HTP12420WN	12	110	420W	341	173	215	219	34.00	3660	3.9	9	F18
HTP12450WN	12	115	450W	376	172	221	225	37.50	3750	2.5	9	F18
HTP12505WN	12	130	505W	338	173	276	281	42.00	3183	4	9	F18
HTP12550WN	12	140	550W	338	173	276	281	45.00	3850	3.5	9	F18
HTP12710WN	12	200	710W	532	207	214	219	58.00	3350	3	22	F18
HTP12820WN	12	230	820W	522	238	219	224	66.40	4040	2.5	22	F18

FRONT TERMINAL TYPE (EUROBAT CLASSIFICATION : VERY LONG LIFE >12 YEARS)

HTP12345WFT	12	100	345W	507	106	235	235	30.00	2124	4.3	23	F18
HTP12450WFT	12	150	450W	550	110	288	288	44.30	2432	4.5	23	F18
HTP12500WFT	12	150	500W	550	110	288	288	50.50	2670	4.5	23	F18
HTP12600WFT	12	160	600W	550	110	288	288	54.00	2800	3.2	23	F18
HTP12710WFT	12	190	710W	546	125	320	320	60.00	3481	3.8	23	F18

Effect of temp on capacity 25°C(77°F)

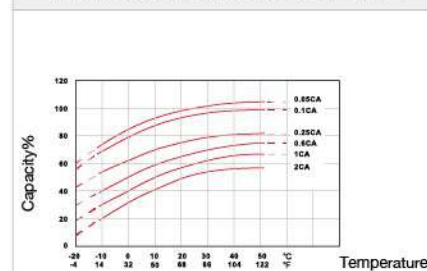

Relationship between temperature and charge voltage

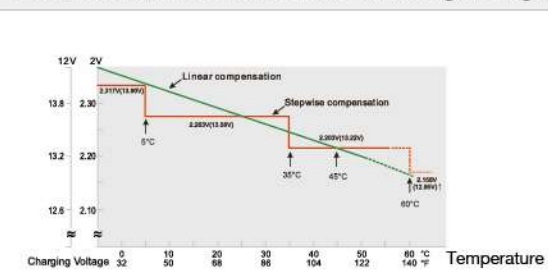

Trickle (or float) service life

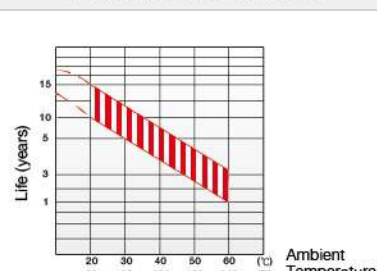

DISCHARGE WATTS PER CELL TO 1.67V/cell AT 25°C

BATTERY MODEL	MINUTES					
	5	10	15	20	30	60
HTP12245WN	423	323	249	209	153	87.9
HTP12265WN	484	340	262	214	159	92.5
HTP12300WN	633	435	340	268	203	98.9
HTP12365WN	747	484	365	291	216	123
HTP12420WN	805	547	444	335	249	146
HTP12450WN	869	601	477	360	288	164
HTP12505WN	837	615	508	403	291	142
HTP12550WN	1023	738	553	462	325	175
HTP12710WN	1180	848	711	605	467	268
HTP12820WN	1200	964	818	624	493	284
HTP12500WFT	643	542	499	-	297	187
HTP12710WFT	950	827	708	-	485	270

DISCHARGE WATTS PER CELL TO 1.70V/cell AT 25°C

BATTERY MODEL	MINUTES					
	5	10	15	20	30	60
HTP12245WN	409	314	247	206	152	87.4
HTP12265WN	467	334	259	212	158	92.3
HTP12300WN	608	426	333	265	201	98.7
HTP12365WN	726	474	359	287	214	122
HTP12420WN	775	533	441	332	247	146
HTP12450WN	837	586	474	357	285	164
HTP12505WN	797	605	505	393	287	139
HTP12550WN	963	705	543	457	322	173
HTP12700WN	996	819	702	586	449	259
HTP12780WN	1142	919	778	599	479	276
HTP12500WFT	613	525	489	-	291	186
HTP12710WFT	921	777	683	-	470	269

DISCHARGE WATTS PER CELL TO 1.75V/cell AT 25°C

BATTERY MODEL	MINUTES					
	5	10	15	20	30	60
HTP12245WN	390	295	244	203	150	86.6
HTP12265WN	442	317	252	207	156	91.7
HTP12300WN	573	415	326	261	197	98.4
HTP12365WN	686	454	345	277	208	119
HTP12420WN	738	518	439	329	244	145
HTP12450WN	797	570	472	353	282	163
HTP12505WN	740	587	479	377	281	148
HTP12550WN	893	672	530	450	317	171
HTP12710WN	997	805	679	560	432	248
HTP12820WN	1083	874	750	574	464	269
HTP12500WFT	580	505	456	-	272	182
HTP12710WFT	881	728	629	-	450	267

DISCHARGE WATTS PER CELL TO 1.80V/cell AT 25°C

BATTERY MODEL	MINUTES					
	5	10	15	20	30	60
HTP12245WN	361	271	225	190	147	85.9
HTP12265WN	404	304	245	202	152	90
HTP12300WN	530	400	311	250	187	97.9
HTP12365WN	639	428	328	264	199	116
HTP12420WN	675	503	424	321	236	143
HTP12450WN	729	553	456	345	274	161
HTP12505WN	683	542	433	354	271	147
HTP12550WN	803	630	515	440	312	163
HTP12710WN	957	790	644	545	413	237
HTP12820WN	1024	829	678	549	449	261
HTP12500WFT	523	450	405	-	241	175
HTP12710WFT	792	673	569	-	426	260



LONG SERVICE LIFE SERIES (EUROBAT CLASSIFICATION: LONG LIFE 10/12 YEARS)

BATTERY MODEL	NOMINAL VOLTAGE (V)	NOMINAL CAPACITY (Ah)		DIMENSION				WEIGHT (APPROX.) kg	TERMINAL POSITION	TERMINAL TYPE
		5HR	20HR	L	W	H	HT			
WPL5-12	12	4.25	5	90	70	101.5	107	1.85	3	F1
WPL5-12SHR	12	4.25	5	90	70	101.5	107	1.93	3	F2
WPL7.2-12	12	6.12	7.2	151	65	94	102	2.40	5	F1
WPL1235W	12	35W	8.5	151	65	94	102	2.70	5	F2
WPL12-12	12	10.2	12	151	98	93	98	4.02	5	F1
WPL14-12S	12	11.9	14	151	98	95	100	4.30	5	F2
WPL18-12(N)SHR	12	15.3	18	181	76	167	167	5.67	11 (14)	F3 (F6)
WPL26-12(N)B	12	22.1	26	166	175	125	125	8.00	21 (14)	F3 (F6)
WPL26-12 (N)	12	22.1	26	166	175	125	125	9.30	21 (14)	F3 (F6)
WPL28-12TN	12	23.8	28	166	125.5	176	176	9.18	14	F6
WPL28-12TM	12	23.8	28	166	125.5	176	176	9.18	14	F9
WPL34-12N	12	28.9	34	197	131	159	168	10.30	9	F6
WPL36-12N	12	30.6	36	197	131	159	168	11.00	9	F8
WPL40-12N	12	34	40	197.7	166	171	171	13.40	14	F8
WPL45-12N	12	38.25	45	199	166	171	171	14.60	14	F8
WPL50-12N	12	42.5	50	199	166	171	171	14.80	14	F8
WPL55-12N	12	46.75	55	226	135	207	214	17.00	9	F8
WPL60-12AN	12	51	60	350	167	179	179	20.50	14	F8
WPL60-12ARN	12	51	60	350	167	179	179	20.50	9	F8
WPL65-12AN	12	55.25	65	350	167	179	179	21.00	14	F8
WPL65-12ARN	12	55.25	65	350	167	179	179	21.00	9	F8
WPL90-12N	12	76.5	90	329.5	172.3	215	222	29.00	14	F18
WPL100-12N	12	85	100	329.5	172.3	215	222	31.30	14	F18
WPL100-12RN	12	85	100	329.5	172.3	215	222	31.30	9	F18
WPL120-12N	12	102	120	408	177	224	224	35.50	14	F18
WPL120-12RN	12	102	120	408	177	224	224	35.50	9	F18
WPL125-12RN	12	106.25	125	408	177	224	224	39.60	9	F18
WPL130-12N	12	110.5	130	483	170	240	240	42.60	9	F18
WPL150-12N	12	127.5	150	483	170	240	240	45.50	9	F18
WPL155-12N	12	131.75	155	483	170	240	240	48.20	9	F18
WPL200-12BN	12	170	200	522	238	219	224	61.50	22	F18
WPL200-12N	12	170	200	522	238	219	224	68.00	22	F18
WPL230-12N	12	195.5	230	522	238	219	224	73.20	22	F18
KPH100-12AN	12	85	100	307	168	208	214	30.00	9	F8
KPH110-12N	12	93.5	110	338	170	212	217	31.20	9	F8
KPH150-12N	12	127.5	150	352	170	273	278	46.00	9	F8

FRONT TERMINAL TYPE (EUROBAT CLASSIFICATION: VERY LONG LIFE >12 YEARS)

BATTERY MODEL	NOMINAL VOLTAGE (V)	NOMINAL CAPACITY (Ah)		DIMENSION				WEIGHT (APPROX.) kg	TERMINAL POSITION	TERMINAL TYPE
		5HR	20HR	L	W	H	HT			
TPK12100A	12	85	100	507	106	235	235	31.30	23	F18
TPK12100HS	12	85	100	390	105	280	280	30.40	23	F18
TPK12125	12	106.3	125	550	110	288	288	39.00	23	F18
TPK12150	12	127.5	150	550	110	288	288	50.50	23	F18
TPK12150NA	12	127.5	150	550	110	288	288	45.00	23	F18
TPK12170	12	144.5	170	546	125	317	323	55.00	23	F18
TPK12190	12	161.5	190	546	125	320	320	60.00	23	F18

2V STATIONARY BATTERIES TYPE (EUROBAT CLASSIFICATION: VERY LONG LIFE >12 YEARS)

BATTERY MODEL	NOMINAL VOLTAGE (V)	NOMINAL CAPACITY (Ah)		DIMENSION				WEIGHT (APPROX.) kg	TERMINAL POSITION	TERMINAL TYPE
		5HR	20HR	L	W	H	HT			
MSK400	2	340	400	197	170	333	342.5	25.50	-	F18
MSK440	2	374	440	197	170	333	342.5	29.70	-	F18
MSK500	2	425	500	241	172	329.5	340	33.50	-	F18
MSK600	2	510	600	241	172	329.5	340	35.70	-	F18
MSK1000SN	2	850	1000	303	172	477	488	62.50	-	F18

UPS / HIGH RATE SERIES

BATTERY MODEL	NOMINAL VOLTAGE (V)	NOMINAL CAPACITY (Ah)		DIMENSION				WEIGHT (APPROX.) kg	TERMINAL POSITION	TERMINAL TYPE
		5HR	20HR	L	W	H	HT			
WP634W	6	34W	8.5	151	34	94	100	1.30	2	F2
WP1213W	12	13W	3.3	134	67	59.5	65.5	1.30	4	F2
WP5-12	12	4.25	5	90	70	101.5	107	1.90	3	F2
WP5-12SHR	12	4.25	5	90	70	101.5	107	1.93	3	F2
WP1224W	12	24W	6	151	51	94	101	1.95	5	F2
WP7-12(28W)	12	28W	7	151	65	94	102	2.18	5	F2
WP1234W	12	34W	8.5	151	65	94	102	2.50	5	F2
WP1236W	12	36W	9	151	65	94	102	2.70	5	F2
WP1251W	12	51W	12	151	98	93	98	3.65	5	F2
WP12-12A	12	10.2	12	151	98	93	98	3.75	5	F2
WP18-12NSHR	12	15.3	18	181	76	167	167	5.60	14	F6
WP20-12I	12	17	20	181	76	167	167	5.95	14	F3
WP20-12N	12	17	20	181	76	167	167	5.95	14	F6
WP22-12N	12	18.7	22	181	76	167	167	6.90	14	F6
WP22-12NSHR	12	18.7	22	181	77	170	170	7.00	14	F6
WP26-12N	12	22.1	26	166	175	125	125	9.30	14	F6
WP30-12TN	12	25.5	30	166	125.5	176	176	9.30	14	F6
WP40-12N	12	34	40	197.7	166	171	171	13.40	14	F8
WP45-12N	12	38.25	45	197.7	166	171	171	13.50	14	F8
WP50-12N	12	42.5	50	199	166	171	171	15.10	14	F8

BATTERY CABINET SYSTEMS

KUNG LONG storage cabinets are a superior solution for the safe storage of top terminal batteries and devices containing them. The Battery cabinet is designed to house standard VRLA Batteries with a variable capacity range.

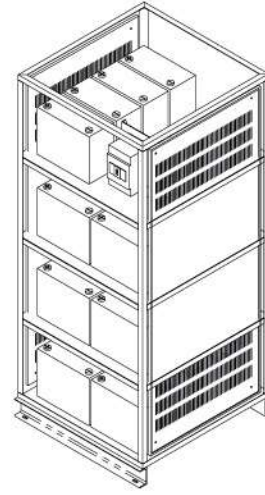

GENERAL FEATURES

1. Robust cabinet
2. Extreme durability
3. Pressure relief filters eliminate smoke and fumes
4. Customized protection device tailored to match your specific power rating
5. Chemical Safety to protect shelves from H2SO4 corrosion that can cause risks of electric shock and short circuit (fire)

BATTERY RACK SYSTEMS

KUNG LONG standard racks have been designed for all types of stationary battery models. These easy-to-use racks are strong, have a flexible design, and are acid-proof. Please contact LONG for information on the different rack lengths and designs available.



GENERAL FEATURES

1. Extreme durability
2. Acid-proof protection
3. Floor mounting brackets included with all racks
4. Racks can be customized with earthquake safety features according to the customer/ project requirement

COOPER CONNECTOR

Bolt screw size(D)	L(A) (mm)	W(B) (mm)	H(C) (mm)	E (mm)	F (mm)
M6	115	30	4	71	97
M6	303	30	4	259	285
M6	236	30	4	192	218
M6	353	30	4	309	335
M6	370	30	4	333.5	352.5
M6	417	30	4	380.5	399.5

Bolt screw size(D)	L(A) (mm)	W(B) (mm)	H(C) (mm)	E (mm)	F (mm)
M6	370	30	10	333.5	352.5
M6	417	30	10	380.5	399.5
M6	134	18	2.5	99	119
M6	107	25	2.5	73	87
M6	140	40	5	95	117

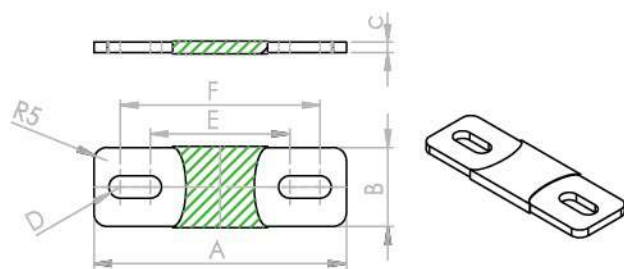

- The product image is for reference purpose. The actual product may be different.
- If you have any connector or wiring needs, please contact our sales team.
- The contents are subjected to change without prior notice.

TERMINAL POSITION

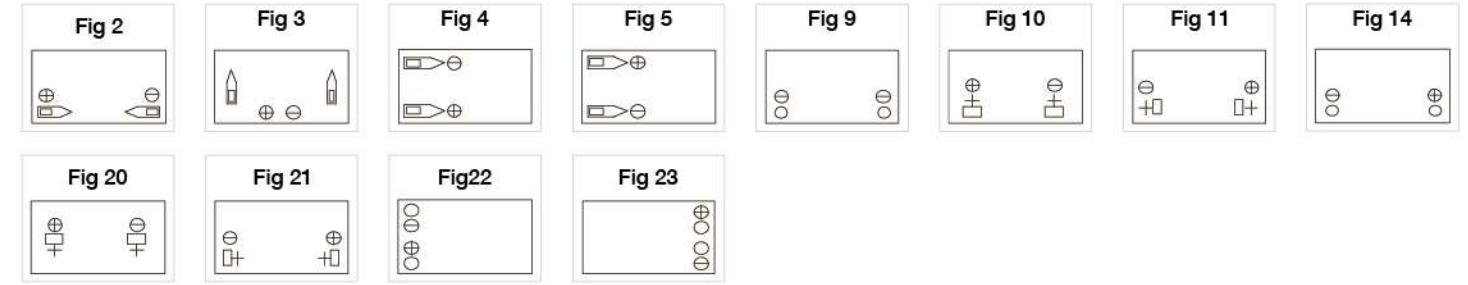

TERMINAL TYPE



DISCHARGE PROTECTION OF BATTERIES

DISCHARGE CURRENT (A)	FINAL DISCHARGE VOLTAGE (V/cell)	RECOMMENDED SETTING FOR EQUIPMENT(V/cell)
(A) ≤ 0.2C	1.75	1.75 ↑
0.2C < (A) ≤ 0.5C	1.70	1.75 ↑
0.5C < (A) ≤ 3.0C	1.60	1.75 ↑
(A) > 3.0C	1.40	1.75 ↑

TORQUE VALUE OF HARD WARE FOR THE TERMINALS

DIAMETER	RECOMMENDED TORQUE VALUE	MAXIMUM ALLOWABLE TORQUE VALUE
M5	4 N-m (41kgf-cm)	6 N-m (61kgf-cm)
M6	7 N-m (71kgf-cm)	10 N-m (102kgf-cm)
M8	12 N-m (122kgf-cm)	20 N-m (204kgf-cm)

CHARACTERISTIC

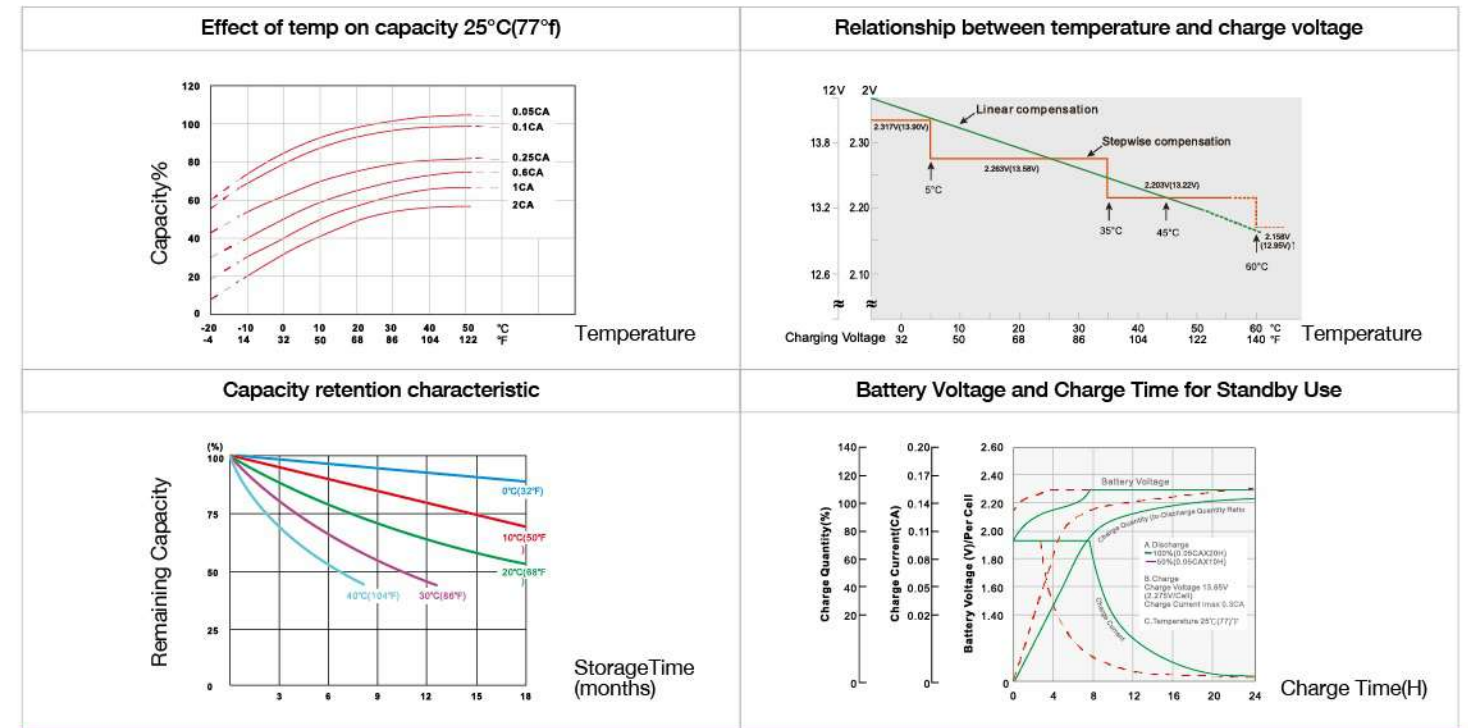



HEADQUARTER

TAIWAN

KUNG LONG BATTERIES INDUSTRIAL CO., LTD.
TEL: + 886-49-2254777
Email: sales@mail.klb.com.tw
http://www.KLB.com.tw

FACTORY

VIETNAM

LE LONG VIET NAM CO., LTD.
TEL:+84-272-37779666
http://www.lelong.com.vn

NORTH AMERICAN SERVICE

USA

TEL: +1-9493078720
Email: sales@kunglong.com

POWER YOUR LIFE



©Copyright 2024.03

All rights of the manufacturer and of the owner of recorded work reserved. Unauthorized duplication is violation of applicable laws. Manufactured and printed in Taiwan. Contents in this catalog are subject to change for improvement without prior notice to users. For clarifications and updated information, please contact us.



www.klb.com.tw